



# 2015 JAY SERIES

*Fold Out the Fun*

## 1209SC | 2015 JAY SERIES

**\$14,423 MSRP**

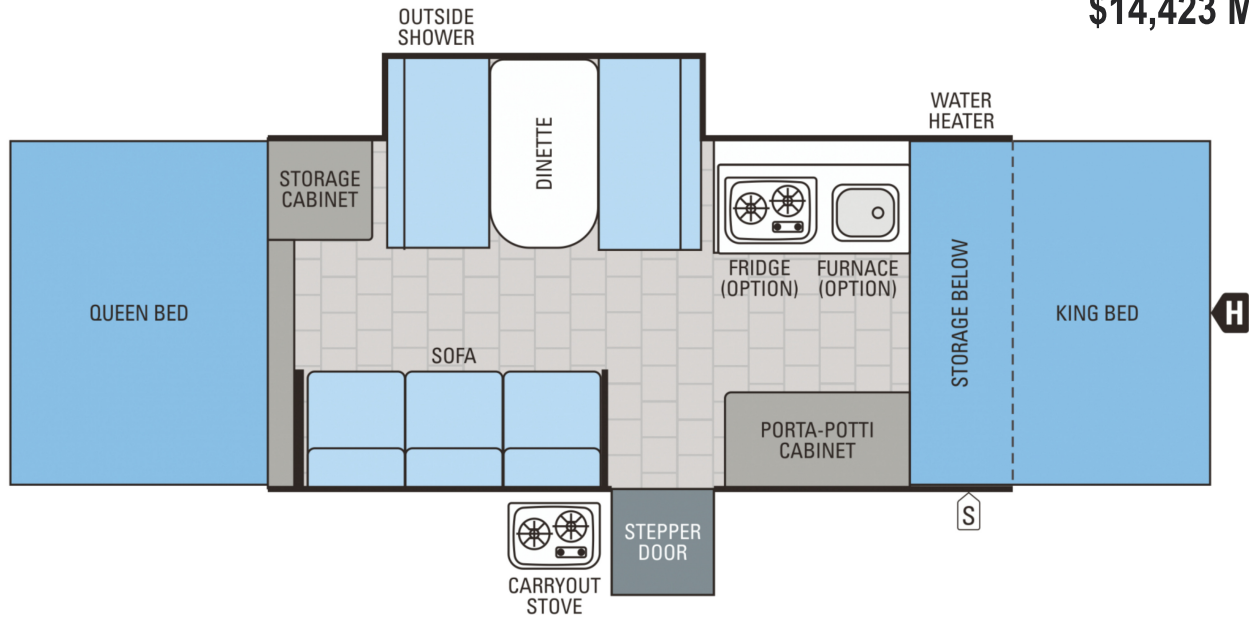

BSH

The options for this floorplan are listed below.

<input type="checkbox"/> Canadian Standards	\$120.00
<input checked="" type="checkbox"/> Customer Value Package (Mandatory) [?]	\$817.00
<input type="checkbox"/> Bath/shower with hard walls	\$2,129.00
<input type="checkbox"/> (2) Bed mat heaters	\$262.00
<input type="checkbox"/> Stereo w/ outside speakers	\$187.00
<input type="checkbox"/> Powered roof vent	\$210.00
<input type="checkbox"/> 16,000-BTU furnace w/ auto ignition	\$397.00
<input type="checkbox"/> Hydraulic surge brakes	\$322.00
<input type="checkbox"/> Deluxe screen room	\$367.00
<input type="checkbox"/> Exterior grill	\$210.00

### Weights & Measures

#### WEIGHTS

Unloaded Vehicle Weight (lbs)	2,460
-------------------------------	-------

Dry Hitch Weight (lbs)	315
Gross Vehicle Weight Rating (lbs)	3,450
Cargo Carrying Capacity (lbs)	990
<b>MEASUREMENTS</b>	
Travel Length	18' 2"
Campsite Length	23' 4"
Exterior Width	85"
Travel Height	60"
Interior Living Area Height	84"
Front Bunk	70 x 80
Rear Bunk	60 x 80
Sofa	36 x 72
Wheel Base	152-1/8"
<b>TANK CAPACITIES</b>	
Fresh Water Capacity (gals) includes water heater	23
Gray Waste Water Capacity (gals)	11*
Black Waste Water Capacity (gals)	5*
<b>OTHER</b>	
Sleeping Capacity	6-7

\*With optional bath/shower

## Images of the 2015 Jay Series 1209SC





---

**JAYCO, INC.**  
903 S. MAIN STREET  
MIDDLEBURY, IN 46540  
PHONE: 574-825-5861

© 2014 JAYCO, INC.