

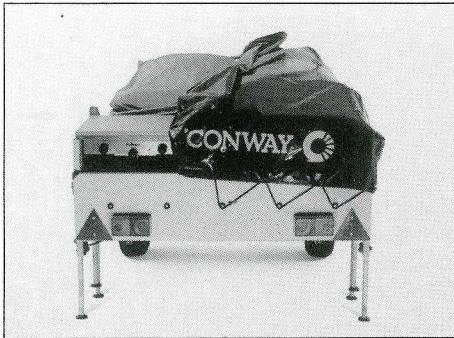

CAPRI & CALYPSO

Step by step instructions for simple erecting.

To fold down, reverse procedure.



1 Level trailer, drop jack legs, remove cover.

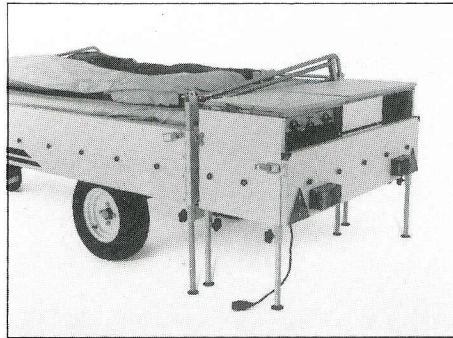

2 Drop the four kitchen support legs to within 1/2" off the ground, release the two protex fasteners. Disconnect the 7 pin plug before removing the kitchen from the slide support rails.

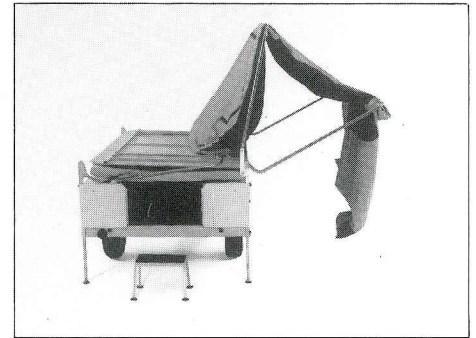

3 Swing over right hand cabin roof support frames.

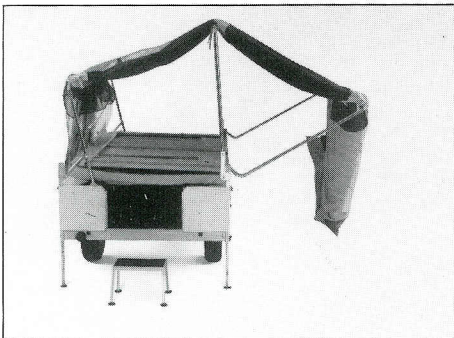

4 Swing over left hand support frame.

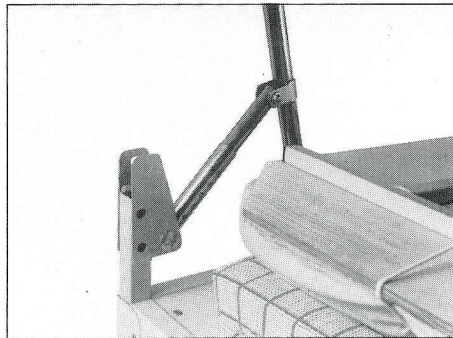

5 Locate button clip on hinged arm.

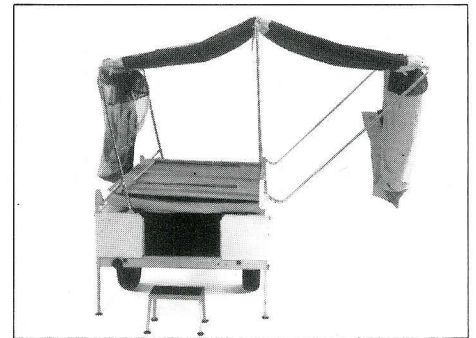

6 Extend three roof support frames, locating button clip on middle hole.

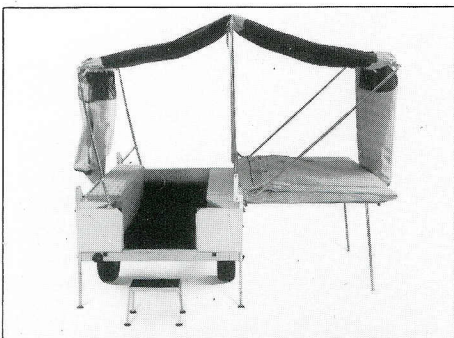

7 Lift over bed board and mattress.

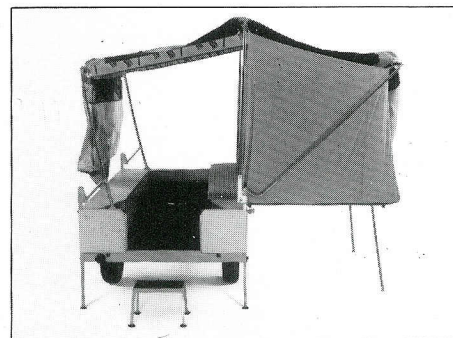

8 Clip inner tent to framework.

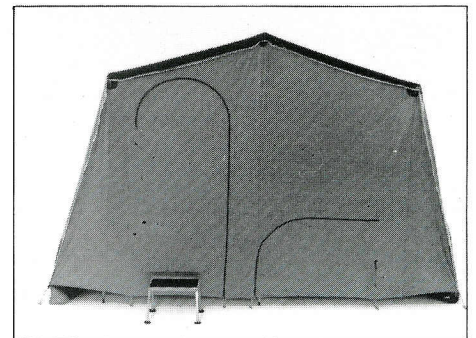

9 Pull canvas down. If using as overnight stop without extensions, close door zip and peg out.

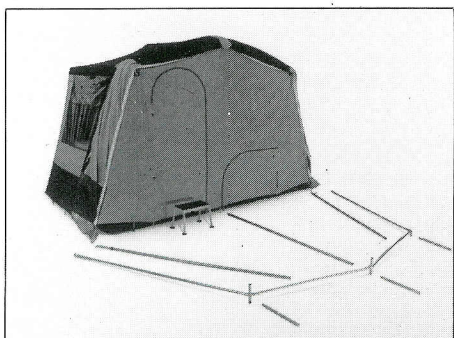

10 Zip on extension canvas and fold back over main body. Lay out extension frame.

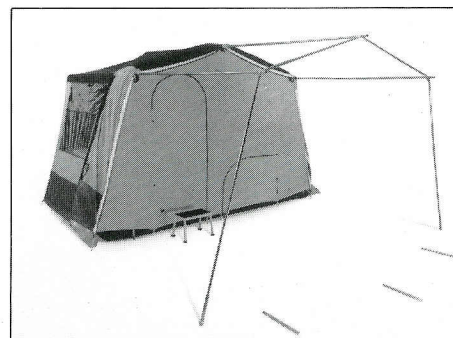

11 Hook roof support poles to main body frame and build up extension frame.

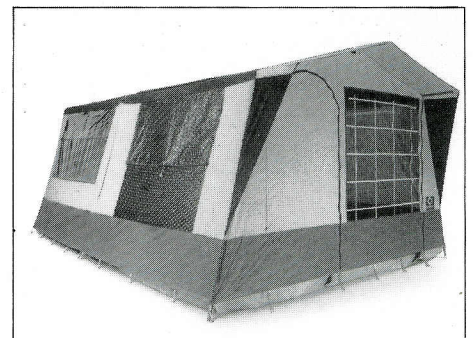

12 Pull over extension canvas and fit stub canopy poles, then tension the frame.

Cabin Frame

Extension Frame

REF. NO.	PART NO.	QUANTITY	DESCRIPTION	REF. NO.	PART NO.	QUANTITY	DESCRIPTION	REF. NO.	PART NO.	QUANTITY	DESCRIPTION
1	T-ST9300	3	Cabin Roof Pole	7a	T-ST9379	1	Cabin Rear N/S Lower Pole Assembly	14	T-ST9976	2	Lower Support Leg
2	T-ST9382	2	Cabin Centre Upper Pole	8	T-ST9381	2	Fixing Strut Outer Tube	15	T-ST10050	2	Adjustable Foot
3	T-ST9383	2	Cabin Nearside Upper Pole	9	CF1002	2	Pole Channel	16	T-ST10046	3	Stub Canopy Pole
4	T-ST9384	2	Cabin Offside Upper Pole	10	T-ST9855	3	Long Hooked Pole	17	T-ST9527	1	L/H Corner Branch
5	T-ST9304	2	Cabin Centre Lower Pole	11	T-ST9897	3	Roof Pole Adjuster	18	T-ST9528	1	R/H Corner Branch
6	T-ST9305	2	Cabin Offside Lower Pole	12	T-ST9991	3	Roof Pole	19	T-ST9529	1	Centre 4 Way Branch
7	T-ST9380	1	Cabin Front N/S Lower Pole Assembly	13	T-ST9953	2	Upper Support Leg				

Cabin and Extension Frames

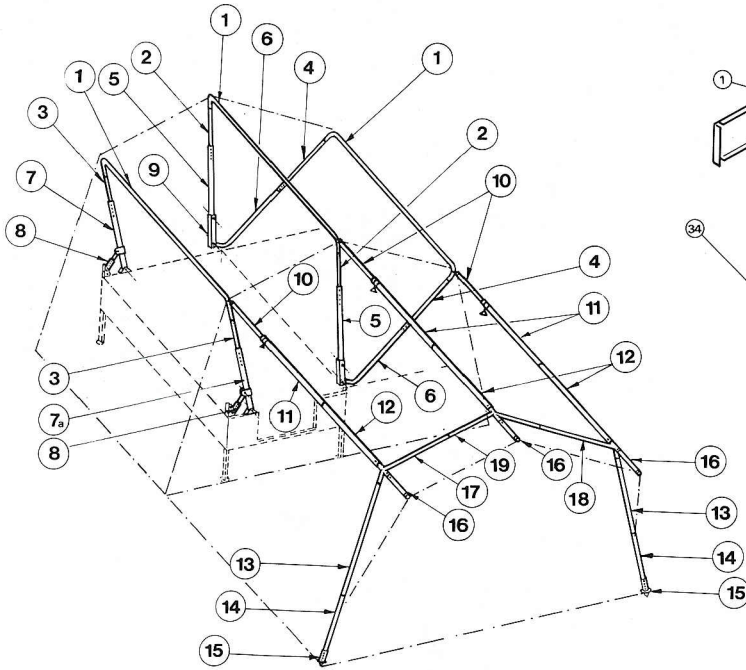

Trailer and Kitchen Parts

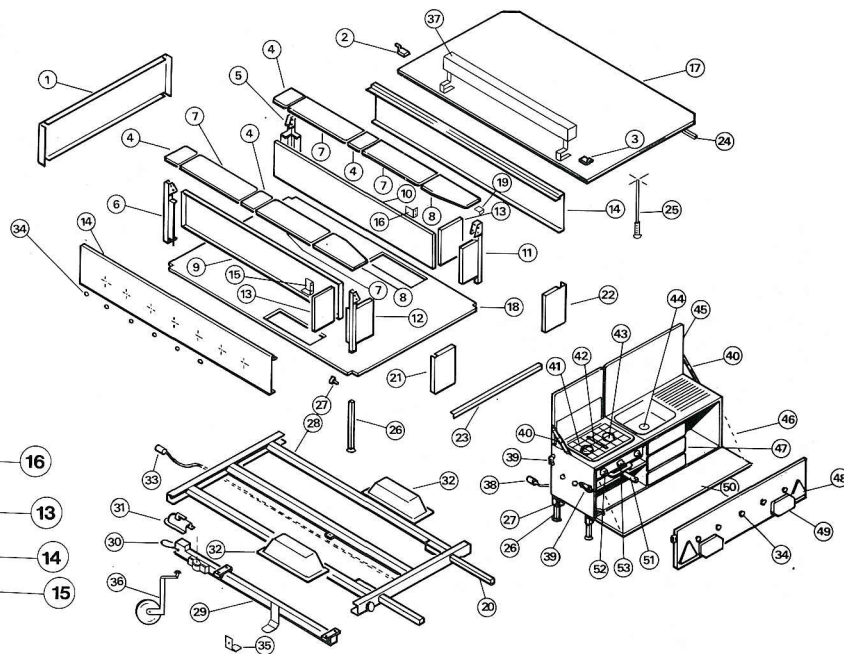

Trailer and Kitchen Parts

REF. NO.	PART NO.	QUANTITY	DESCRIPTION	REF. NO.	PART NO.	QUANTITY	DESCRIPTION	REF. NO.	PART NO.	QUANTITY	DESCRIPTION
1	BD 1014	1	Trailer Front Panel	19	BD 1044	2	Locker End Support Bracket	37	AC 1106	1	Back Rest
2	BB 1004	1	Hinge Front	20	CH 1012	2	Kitchen Runner Loose	38	ST 7000	1	Seven-Pin Plug
3	BB 1006	1	Hinge Rear	21	BS 1016	1	Outer Panel Nearside Rear	39	ST 6001	4	Protex Fastener
4	FR 1040	4	Locker Lid Fixed Piece	22	BD 1017	1	Outer Panel Off Side Rear	40	ST 6008/9	2	Kitchen Top Stay, Right & Left Hand
5	BD 1005	1	Corner Piece Off Side Front	23	BD 1013	1	Carpet Trap	41	ST 6217	1	Cooker Top Grid
6	BD 1004	1	Corner Piece Nearside Front	24	BB 1010	1	Bedboard Stiffening Frame	42	ST 6225	1	Centre Grill
7	BD 1039	4	Locker Lid	25	ST9310	2	Bed Support Leg	43	ST 6224	2	Side Burner
8	BD 1038	2	Locker Tapered Panel	26	BD 1010	4	Jack Leg	44	ST 6401	1	Sink Waste & Plug
9	FR 1036	1	Locker Inner Panel Nearside	27	ST3220	4	Jack Leg Locking Screw	45	KT 1204/5	1	Kitchen Top Large/Small
10	FR 1037	1	Locker Inner Panel Offside	28	CH 1027	1	Chassis	46	ST 6403	2	Support Chain 28" Long
11	BD 1008	1	Corner Piece Off Side Rear	29	RG 1018	1	Drawbar	47	KT 1205	2	Drawer
12	BD 1007	1	Corner Piece Nearside Rear	30	ST 7501	1	Safety Cable & 'U' Bolt	48	ST 7008	2	Reflector
13	FR 1042	2	Locker End Panel	31	ST 7500	1	50mm Coupling - Non Braked	49	ST 7041	2	Rear Light
14	BD 1015	2	Trailer Side Panel	32	ST 6574	2	Wheel Box	50	KT 1102	1	Rear Flap
15	FR 1007	1	Corner Bracket Nearside	33	CH 1006	1	7 Pin Plug & Wiring Harness	51	ST 6215/6	1	Grill Pan and Wire
16	FR 1006	1	Corner Bracket Off Side	34	ST 6502	28	Cover Anchorage Buttons	52	ST 6207	2	Side Burner Control Knob
17	BB1011	1	Bedboard	35	AC 1085	1	Spare Wheel Clamp	53	ST 6208	1	Grill Control Knob
18	BD 1041	1	Baseboard	36	ST 7519	1	Jockey Wheel		ST9166	1	Locker Cushion